

Installation Instructions

Honeycomb Shades

AutoWand™ Motorized Bottom Up

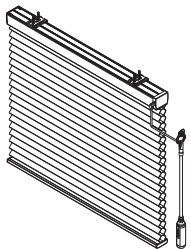

READ BEFORE INSTALLATION

⚠ WARNING! Important safety instructions. Follow all instructions since incorrect installation can lead to severe injury. Before installing the device, remove any unnecessary cords or components and disable any equipment not needed for powered operation.

⚠ WARNING! The installation height will vary according to product type or installation situation and may exceed 98.43".

Getting Started



Remove shade from package. Save packaging until shade is installed and working to your satisfaction.

Tools:

- Level
- Measuring Tape
- Pencil
- Power drill (6mm hex driver and drill bit)
- Screwdriver



You will need to use the following fasteners for your particular mounting surface.

Surface	Fastener
Wood	Screws (Provided) 
Drywall / Plaster	Wall Anchors, Expansion Bolts (Not Provided) 
Metal	Sheet Metal Screws (Not Provided) 

Check Component / Hardware:



Installation Bracket

3/8" Single, 1/2" Double, 9/16" Single, 3/4" Single

- X ≤ 56" x 2pcs
- 56" < X ≤ 105" x 3pcs
- 105" < X ≤ 120" x 4pcs
- (X = Order Width)



1 1/4" Single, 3/4" Double

Spacer Block (Optional)

- 1pc for extend distance 3/8"
- 2pcs for extend distance 11/16"

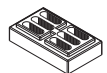

- #8 1 1/4" Hexagon Screw for Installation Bracket
- 2" Screw for Installation Bracket with Spacer Block (Optional)
- Installation bracket qty x 2pcs



x 2pcs
Hold Down bracket (Optional)



x 2pcs
#6 3/4" Screw for Hold Down Bracket (Optional)



x 1pc
3/4" (M3.5x18.5mm) Flat Head Screw for Hook

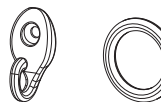

Hook Ring



Charging kit

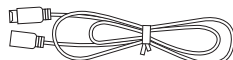

118" Extension cable (Optional)

Note: Optional flat head screws included. Use as needed.

Step 1: Bracket Installation

For the shade to operate properly, it is essential that the mounting brackets are installed level. Use shims if necessary to achieve proper alignment. Ensure all brackets are aligned evenly. Please refer to the drawing below.

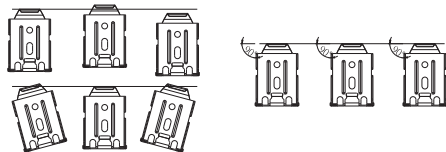

Measure 3" from both ends of the head rail. Mark the bracket location on the mounting surface. Proper alignment of brackets will make installation easier.

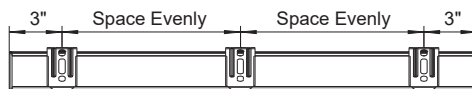

Inside Mount

Align the front of brackets at least 3/8" to the edge of window frame as below drawing. Use two 1 1/4" installation screws to secure brackets. Use wall anchors for drywall or plaster wall.

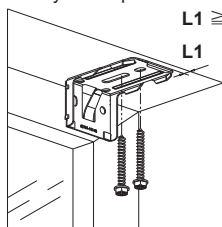

Outside Mount

Use two 1 1/4" installation screws to secure brackets. Use wall anchors for drywall or plaster wall.

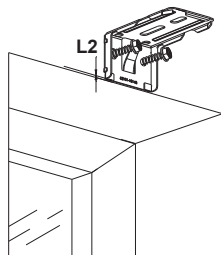

Allocate a min. distance (L2) from the edge of window frame to the bottom of brackets as left drawing.
For 3/8" Single, 1/2" Double, 9/16" Single, 3/4" Single, L2 = 1/16".
For 1 1/4" Single, 3/4" Double, 0 ≤ L2 ≤ 1/4".

Note: If spacer block is required, please follow this guide: Please always make sure the raised side of the spacer block is against the bracket. Use 2" screws for one or two pcs of spacers. See picture below:

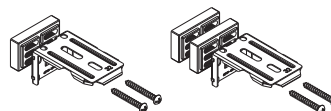

* For shallow mounting, using 2pcs of flat head screw to secure the bracket as below:

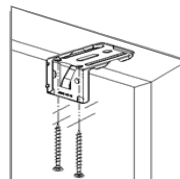

Step 2: Install the Shade

• Position head rail at a slight angle and hook the front of the headrail onto the front edge of the bracket. Then push it upward to snap into the bracket. (Please reference below pictures)

⚠ For proper installation, start with attaching the front of the headrail to the bracket and ensure to stick right in place.

Note: You will hear a click sound once the head rail is properly secured.

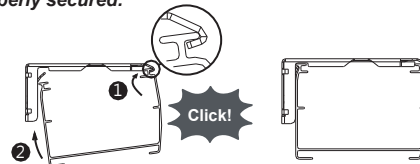

Step 3: Install the AutoWand™

A. Install the Hook.

After the shade is well installed, please mark the position where you will install the hook for the AutoWand™. Please make sure the AutoWand™ cable can connect to the motor after it is put on the hook. Use one 3/4" (M3.5x18.5mm) Flat screw to fix the hook.

* When extension cable is selected to solve the high window applications, it is used to connect the motor to the AutoWand.

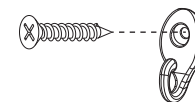

⚠ Make sure the shade could run smoothly after the AutoWand™ is hooked.

B. Operate the Shade

First please attach the AutoWand™ to the hook, and connect the cable to the motor. The shade could be operated once the cable is connected.

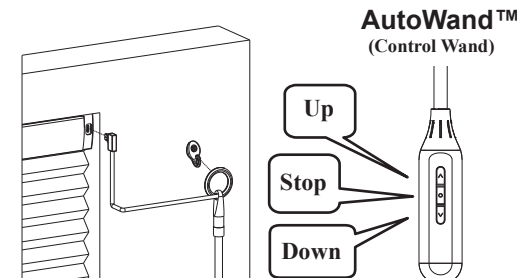

★ Congratulations! You have finished installing the shade.

★ Recharge the AutoWand™

⚠ WARNING: Do not operate the shade while charging.

If the shade moves with intermittent operation, it means the battery is running low. Charge the battery with 5V USB charger via the AutoWand™. (Adapter is not provided) When charging the shade, the indicator light at the bottom of the control wand will flash red, and light will change to green once the battery is fully charged.

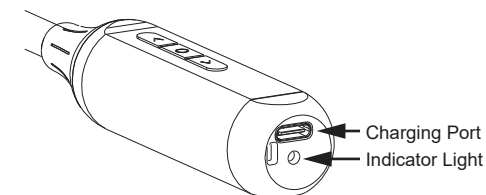

How to Install Hold Down Brackets (optional)

A. For Hold Down Brackets

Use #6 3/4" screw to secure each bracket. Please fasten the screw tightly.

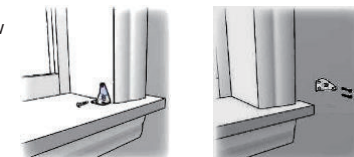

B. For Magnetic Hold Down

Use M3 x 15mm screw to secure the magnet catch at the below location. Make sure the magnet catch aligns with the pre-installed magnet on shade bottom rail.

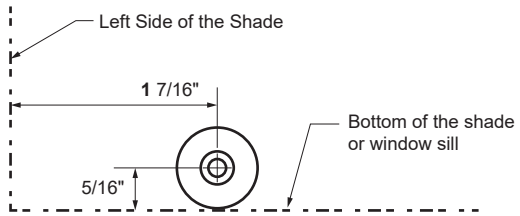

★ Remove the Shade

Fully raise the shade, and then gently pry the bracket off the head rail with a flat screwdriver.

Remove the shade.

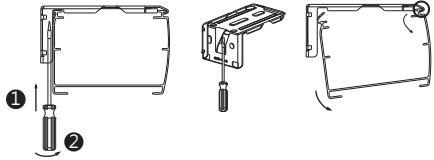

★ Cleaning the Shade

Routine cleaning will help maintain the beauty of your shade. The shade can be cleaned by using a soft brush, vacuumed with a low suction hand-held vacuum, cleaned ultrasonically (specify that a mild solution must be used and that the head rail should never be immersed in liquid). Spot cleaning is not recommended, but if necessary, dampen a clean cloth with a solution of warm water and mild detergent to dab at the spot until it's gone (do not rub!).

⚠ Do not spray the liquid to the electric parts of the motorized shade.

Troubleshooting

Problem	Solution
The shade will not snap into the mounting brackets.	<p>Check if mounting brackets are aligned. Refer to below drawing.</p>
The shade will not lift.	<p>Check if all brackets are locked in place. Refer to below drawing.</p>

Optional Parts Installation

Side Mount Bracket

Side mount bracket is only available for the arch window with shade width $\leq 37"$ and the normal bracket qty should be 2.

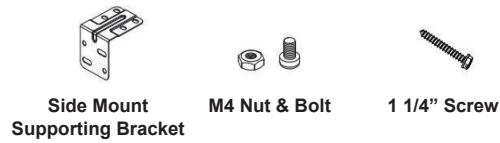

Hardware Standard Quantity

Shade Width (X)	$X \leq 37"$
Installation Bracket	2
1 1/4" Screw for Installation Bracket	4
Side Mount Supporting Bracket	2
M4 Nut & Bolt	4 sets

How to assemble side mount bracket

Align the side mount supporting bracket holes with the installation bracket holes, and then screw the M4 nut & bolt into the diagonal holes for the left side mount bracket. Do the same for the right side mount bracket.

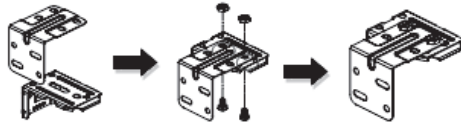

How to install side mount bracket

Put two 1 1/4" mounting screws into the diagonal holes to secure bracket. Use wall anchors for drywall or plaster wall.

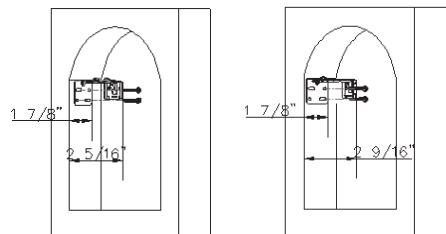

3/8" Single, 9/16" Single
3/4" Single, 1/2" Double

1 1/4" Single, 3/4" Double

Light Guard

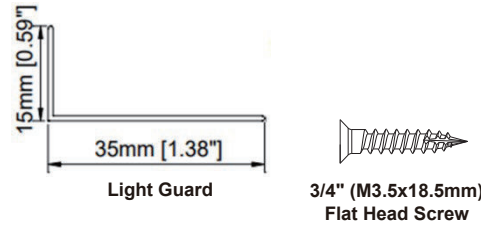

Clear Plastic Tape (only for split light guard)

Install Light Guard (Optional for IB)

Notice: To avoid scraping, leave at least 1/16" (2mm) gap between fabric stack and light guard. The light guard is to be placed at back of the shade on left & right side.

A. When the light guard length $\leq 96"$, place the light guard vertically towards the bottom window frame and then mark out the location with a pencil. Remove the double sided tapes and carefully paste the light guard in position.

Fix 2pcs of 3/4" flat head screws to secure the light guard.

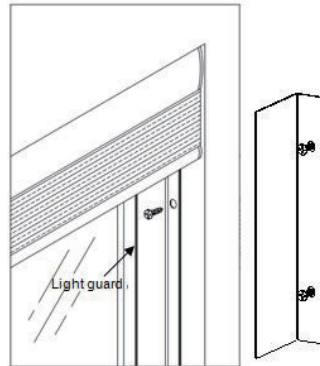

Note: The light guards on both sides are identical; Use the double-sided tape on the narrow side of the light guard to attach to the window frame.

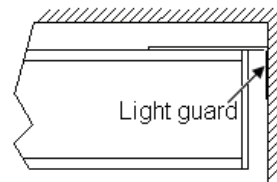

B. When the light guard length exceeds 96", it will be spliced into 2pcs. Stick 2pcs of clear plastic tapes on both sides of the split part to seam the light guard. Place the light guard vertically towards the bottom window frame and then mark out the location with a pencil.

Remove the double sided tapes and carefully paste the light guard in position. Fix 4pcs of 3/4" flat head screws to secure the light guard.

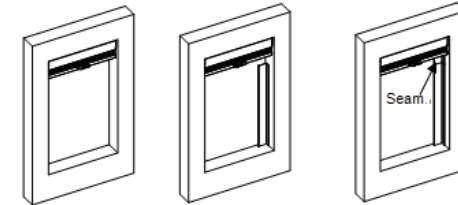
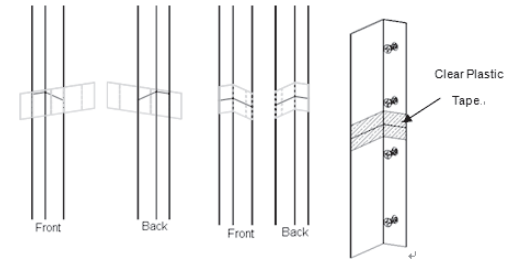

Note: We recommend that the seam be placed on top, shown in above drawings.